

# Product Engineering Guide

## OSM v20 MitsbVCR v11

---

### **Introduction**

The MitsbVCR OSM links Mitsubishi HS-S5600 Series Video Cassette Recorder and HS-S8300 Series Video Cassette Recorder to Observer.

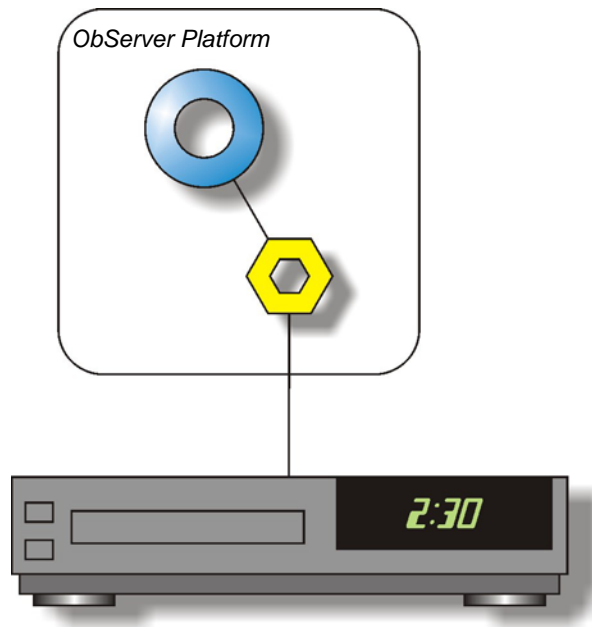

---

## **Engineering**

### **Step 1 – Install OSM**

The MitsbVCR OSM is installed automatically with all ObSys editions. Refer to the 'ObSys CD sleeve' for details on how to install ObSys.

### **Step 2 – Connect COM Port to Mitsubishi HS-S5600 Series Video Cassette Recorder Series or HS-S8300 Series Video Cassette Recorder**

Using cable, connect the Video Cassette Recorder to a COM port of the PC. Refer to the section 'Cable' below for details of the cable.

### **Step 3 – Plug in MitsbVCR OSM to ObServer**

Use object engineering software to locate the ObServer Setup object. Assign the MitsbVCR OSM to an available channel. Refer to '[ObServer v20 Application Engineering Guide](#)'.

Note: After inserting the OSM, your engineering software may need to re-scan the ObServer object in order to view the OSM.

### **Step 4 – Configure MitsbVCR OSM**

The COM port, baudrate, byte format, alarm polling facilities, and alarm destination are configured using objects. Use object engineering software to view and modify the module objects within the OSM.

### **Step 5 – Access Objects within the Mitsubishi HS-S5600 Series Video Cassette Recorder or HS-S8300 Series Video Cassette Recorder**

Values from the Video Cassette Recorder are made available as objects from ObServer. Any object software that is connected to the ObServer can access these objects.

# Engineering Reference

## Cable Specification

The cable between COM port and the 25 way D-type connector labelled RS232 on the Mitsubishi HS-S5600 Series Video Cassette Recorder is as follows:

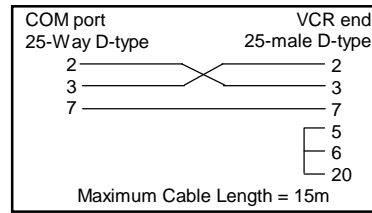
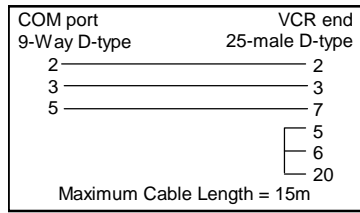

The cable between the COM Port and the Mitsubishi HS-S8300 Series Video Cassette Recorder hardware is as follows:

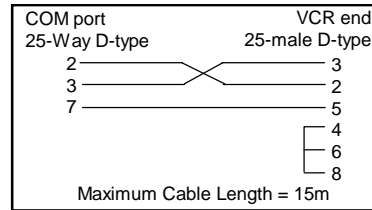
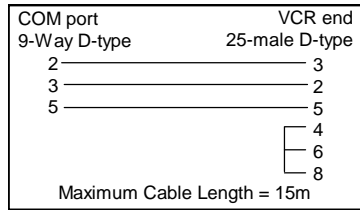

## Objects

When the OSM is loaded the following objects are created within ObServer, use object software to access these objects.

Object <sup>[1]</sup>	Label	R/W	Type
Sc	MitsbVCR System connected to channel c	-	[MitsbVCR v11]
Mc	MitsbVCR Module connected to channel c	-	[OSM v20\ MitsbVCR v11]

## Notes

[1] The ObServer channel number, c, is a number in the range 1...40.